



Electrolux
PROFESSIONAL

**Modular Cooking Range Line
thermaline 80 - 500mm Passth. Electric
Warming Cabinet, 2 doors, GN conform,
2 Sides(H2)-H=550**

ITEM # _____

MODEL # _____

NAME # _____

SIS # _____

AIA # _____



588317 (MA4JDCEOAO)

Passthrough electric
warming cabinet, with 2
doors, two-side operated,
GN - H2

Short Form Specification

Item No. _____

500 mm wide passthrough warming cabinet with 2 doors, constructed according to DIN 18860_2 with 70 mm recessed plinth. Internal frame for heavy duty sturdiness in 2 mm and 3 mm in 1.4301 (AISI 304). 2 mm top in 1.4301 (AISI 304). Flat surface construction

Main Features

- All major components may be easily accessed from the front.
- THERMODUL connection system creates a seamless work top when units are connected to each other thus avoiding soil penetrating vital components and facilitating the removal of units in case of replacement or service.
- Unit constructed according to DIN 18860_2 with 70 mm recessed plinth.
- Temperature in the cupboard can be set through a thermostat to suit different requirements. The maximum temperature is 110°C.
- [NOT TRANSLATED]

Construction

- IPX5 water resistance certification.
- 2 mm top in 1.4301 (AISI 304).
- Flat surface construction with minimal hidden areas to easily clean all surfaces
- Storage space in the base of the appliance accepts GN1/1 containers.
- Internal frame for heavy duty sturdiness in stainless steel.

APPROVAL: _____



Experience the Excellence
www.electroluxprofessional.com

Front

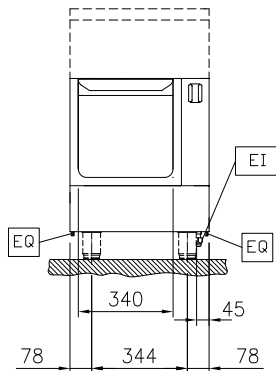

Side

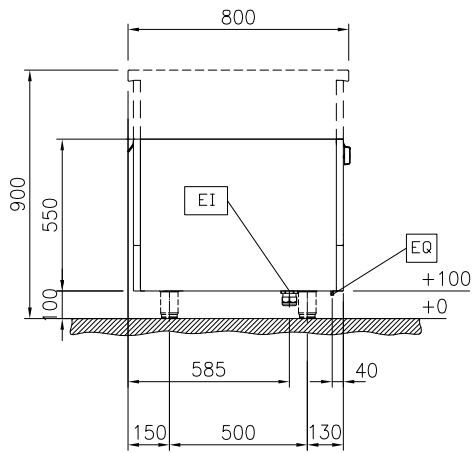

EI = Electrical inlet (power)

Top

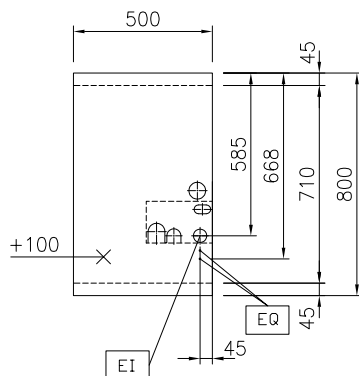

Key Information:

| | |
|--------------------------------------|-----------|
| External dimensions, Width: | |
| 588317 (MA4JDCEOAO) | 500 mm |
| External dimensions, Depth: | 800 mm |
| External dimensions, Height: | 550 mm |
| Cupboard Cavity Dimensions (width): | 340 mm |
| Cupboard Cavity Dimensions (height): | 330 mm |
| Cupboard Cavity Dimensions (depth): | 710 mm |
| Cabinet temperature range: | 30-110 °C |
| Net weight: | 27 kg |

Sustainability

| | |
|----------------------|----------|
| Current consumption: | 2.5 Amps |
|----------------------|----------|

Optional Accessories

- Stainless steel side panel (12mm), 800x800mm, freestanding PNC 912508 ☐
- Stainless steel front kicking strip, 500mm width PNC 912595 ☐
- Stainless steel side kicking strips left and right, freestanding, 800mm width PNC 912619 ☐
- Stainless steel plinth, freestanding, 500mm width PNC 912822 ☐
- - NOT TRANSLATED - PNC 913233 ☐
- - NOT TRANSLATED - PNC 913244 ☐
- - NOT TRANSLATED - PNC 913257 ☐
- - NOT TRANSLATED - PNC 913279 ☐
- - NOT TRANSLATED - PNC 913669 ☐
- - NOT TRANSLATED - PNC 913676 ☐
- - NOT TRANSLATED - PNC 913685 ☐